

NOTE: BREAK ALL CORNERS WITH 0.015" (0.38 MM) RADIUS UNLESS OTHERWISE NOTED. STANDARD TOLERANCES TO APPLY UNLESS OTHERWISE SPECIFIED.

CUSTOMER PART No.	CUSTOMER <b>WOLVERINE STD</b>	WLV DIE No. <b>WH11786</b>	REV No. <b>0</b>
DESCRIPTION <b>4" SCH 10 PIPE</b>		QUOTE No. <b>24-1047-1</b>	PROPOSAL No. <b>H-19264</b>

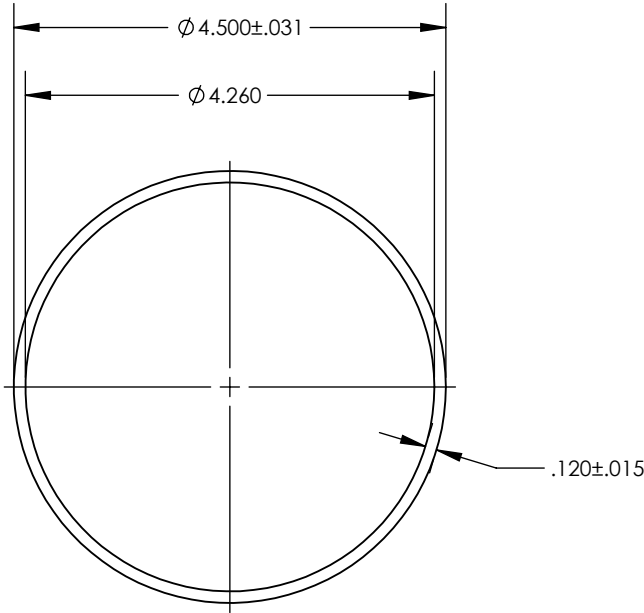

WALL THICKNESS .120 ± .015

DATE	REV	DESCRIPTION	BY
EST. AREA	1.651	IN. <sup>2</sup>	EST. AREA 1065.159
EST. WT.	1.933	LBS/FT.	EST. WT. 2.877
EST. PER.	27.520	IN.	EST. PER. 699.008
OUT PER.	14.137	IN.	OUT PER. 359.080
C.C.D.	4.500	IN.	C.C.D. 114.300
FACTOR 14	FINISH M/F	ALLOY & TEMP.	6061/6063/6005A
CKD BY	SCALE 1:2	DWN BY <b>B.A.</b>	DATE 1/17/24

**WOLVERINE**

2100 MARKET STREET  
DECATUR, AL 35816  
800-633-3972

THIS DRAWING IS NOT NECESSARILY A COPY OF YOUR ORIGINAL. PLEASE APPROVE DIMENSIONS AND TOLERANCES INDICATED. WOLVERINE ASSUMES NO RESPONSIBILITY EITHER TECHNICAL OR LEGAL FOR HAVING THIS SHAPE MADE. THE CUSTOMER AGREES TO FULLY PROTECT WOLVERINE FROM CLAIMS OF OTHERS RESULTING FROM THIS SHAPE.

**SIGNED:** \_\_\_\_\_ **DATE:** \_\_\_\_\_

**PRINT NAME:** \_\_\_\_\_