

NOTE: BREAK ALL CORNERS WITH 0.015" (0.38 MM) RADIUS UNLESS OTHERWISE NOTED. STANDARD TOLERANCES TO APPLY UNLESS OTHERWISE SPECIFIED.

CUSTOMER PART No.	CUSTOMER WOLVERINE STD	WLV DIE No. WH11784	REV No. 0
DESCRIPTION 3" SCH 10 PIPE	QUOTE No. 24-1057-1	PROPOSAL No. H-19281	

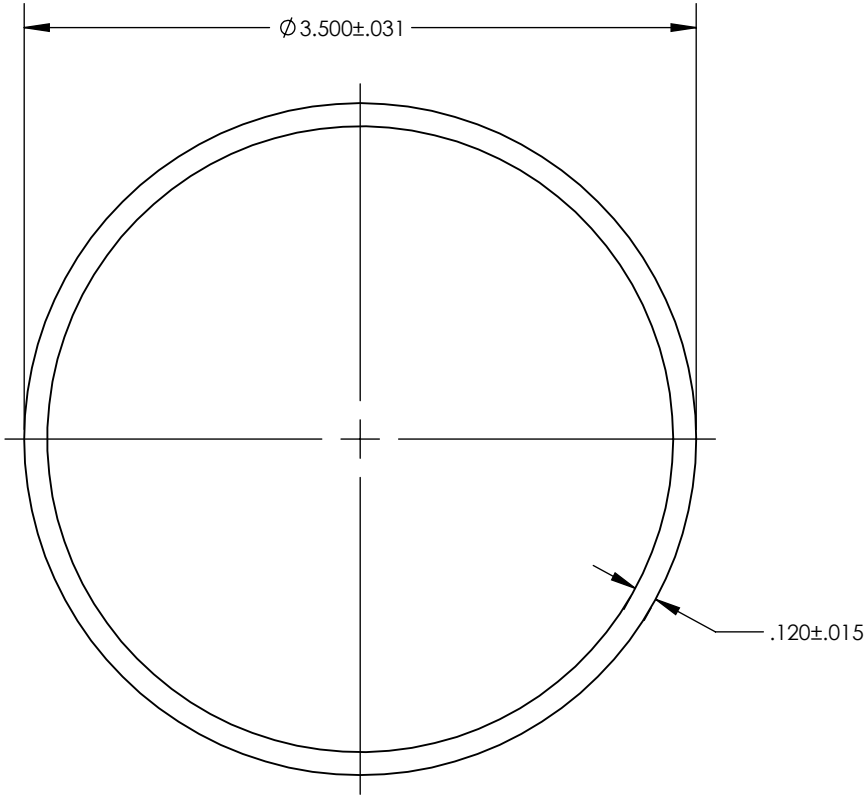

WALL THICKNESS .120 ± .015

DATE	REV	DESCRIPTION				BY
EST. AREA	1.274	IN. ²	EST. AREA	821.934	MM. ²	
EST. WT.	1.492	LBS/FT.	EST. WT.	2.220	KG/M	
EST. PER.	21.237	IN.	EST. PER.	539.420	MM.	
OUT PER.	10.996	IN.	OUT PER.	279.298	MM.	
C.C.D.	3.500	IN.	C.C.D.	88.900	MM.	
FACTOR 14		FINISH M/F		ALLOY & TEMP. 6063		
CKD BY		SCALE 1:1		DWN BY B.A.	DATE 1/23/24	

WOLVERINE

2100 MARKET STREET
DECATUR, AL 35816
800-633-3972

THIS DRAWING IS NOT NECESSARILY A COPY OF YOUR ORIGINAL. PLEASE APPROVE DIMENSIONS AND TOLERANCES INDICATED. WOLVERINE ASSUMES NO RESPONSIBILITY EITHER TECHNICAL OR LEGAL FOR HAVING THIS SHAPE MADE. THE CUSTOMER AGREES TO FULLY PROTECT WOLVERINE FROM CLAIMS OF OTHERS RESULTING FROM THIS SHAPE.

SIGNED: _____ DATE: _____

PRINT NAME: _____