

NOTE: BREAK ALL CORNERS WITH 0.015" (0.38 MM) RADIUS UNLESS OTHERWISE NOTED. STANDARD TOLERANCES TO APPLY UNLESS OTHERWISE SPECIFIED.

CUSTOMER PART No.	CUSTOMER <b>WOLVERINE STD</b>	WLV DIE No. <b>WH11736</b>	REV No. <b>0</b>
DESCRIPTION <b>4" SCH. 80 PIPE</b>		QUOTE No. <b>22-1375-1</b>	PROPOSAL No. <b>H-16990</b>

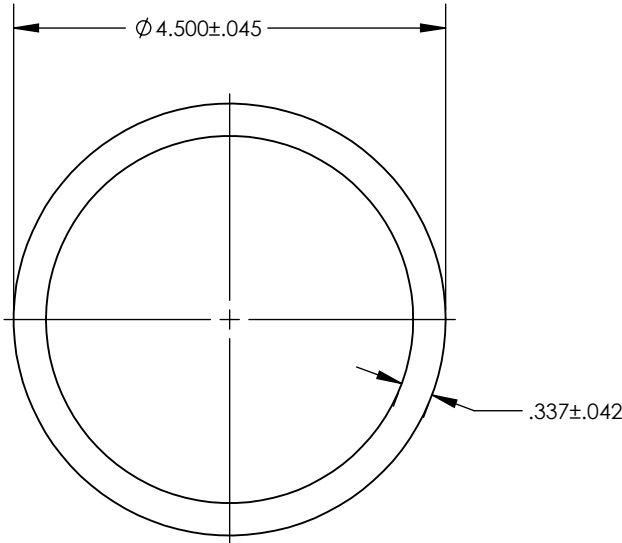

WALL THICKNESS .337

DATE	REV	DESCRIPTION	BY
EST. AREA	4.407	IN. <sup>2</sup>	EST. AREA 2843.220
EST. WT.	5.159	LBS/FT.	EST. WT. 7.674
EST. PER.	26.157	IN.	EST. PER. 664.388
OUT PER.	14.137	IN.	OUT PER. 359.080
C.C.D.	4.500	IN.	C.C.D. 114.300
FACTOR 5	FINISH M/F	ALLOY & TEMP. 6061	
CKD BY	SCALE 1:2	DWN BY <b>B.A.</b>	DATE 5/11/22

**WOLVERINE**

2100 MARKET STREET  
DECATUR, AL 35816  
800-633-3972

THIS DRAWING IS NOT NECESSARILY A COPY OF YOUR ORIGINAL. PLEASE APPROVE DIMENSIONS AND TOLERANCES INDICATED. WOLVERINE ASSUMES NO RESPONSIBILITY EITHER TECHNICAL OR LEGAL FOR HAVING THIS SHAPE MADE. THE CUSTOMER AGREES TO FULLY PROTECT WOLVERINE FROM CLAIMS OF OTHERS RESULTING FROM THIS SHAPE.

**SIGNED:** \_\_\_\_\_ **DATE:** \_\_\_\_\_

**PRINT NAME:** \_\_\_\_\_