

NOTE: BREAK ALL CORNERS WITH 0.015" (0.38 MM) RADIUS UNLESS OTHERWISE NOTED. STANDARD TOLERANCES TO APPLY UNLESS OTHERWISE SPECIFIED.

CUSTOMER PART No.	CUSTOMER WOLVERINE STD	WLV DIE No. WH11412	REV No. 0
DESCRIPTION 5" SCH. 40 PIPE	QUOTE No. 22-1625-5	PROPOSAL No. H-17416	

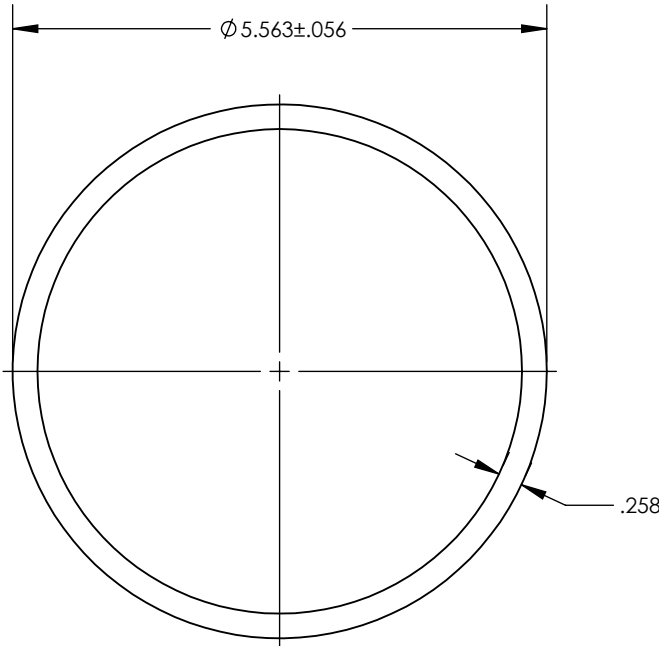

WALL THICKNESS .258

DATE	REV	DESCRIPTION				BY
EST. AREA	4.300	IN. ²	EST. AREA	2774.190	MM. ²	
EST. WT.	5.033	LBS/FT.	EST. WT.	7.490	KG/M	
EST. PER.	33.332	IN.	EST. PER.	846.633	MM.	
OUT PER.	17.477	IN.	OUT PER.	443.154	MM.	
C.C.D.	5.563	IN.	C.C.D.	141.300	MM.	
FACTOR 7		FINISH M/F	ALLOY & TEMP. 6061-T6			
CKD BY		SCALE 1:2	DWN BY B.A.	DATE 8/25/22		

WOLVERINE

2100 MARKET STREET
DECATUR, AL 35816
800-633-3972

THIS DRAWING IS NOT NECESSARILY A COPY OF YOUR ORIGINAL. PLEASE APPROVE DIMENSIONS AND TOLERANCES INDICATED. WOLVERINE ASSUMES NO RESPONSIBILITY EITHER TECHNICAL OR LEGAL FOR HAVING THIS SHAPE MADE. THE CUSTOMER AGREES TO FULLY PROTECT WOLVERINE FROM CLAIMS OF OTHERS RESULTING FROM THIS SHAPE.

SIGNED: _____ DATE: _____

PRINT NAME: _____