

NOTE: BREAK ALL CORNERS WITH 0.015" (0.38 MM) RADIUS UNLESS OTHERWISE NOTED. STANDARD TOLERANCES TO APPLY UNLESS OTHERWISE SPECIFIED.

CUSTOMER PART No.	CUSTOMER WOLVERINE STD	WLV DIE No. WH10315	REV No. 0
DESCRIPTION 2.000 x .1875 ROUND TUBE	QUOTE No. 19-1034-3	PROPOSAL No. H-11110	

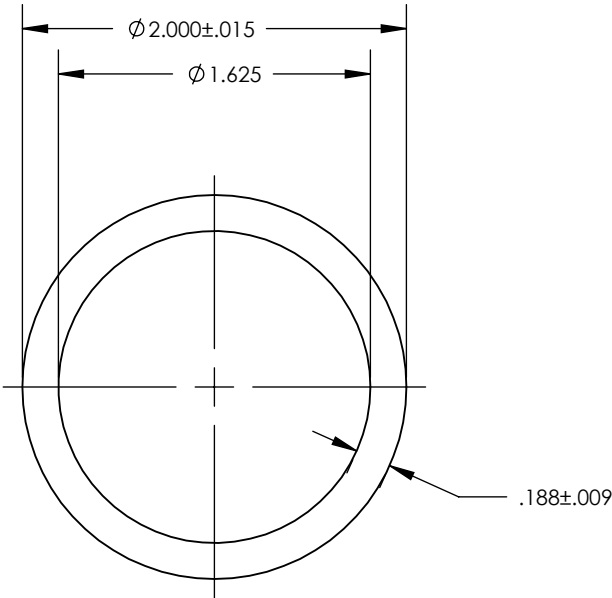

WALL THICKNESS .187 ± .009

DATE	REV	DESCRIPTION	BY
EST. AREA	1.065	IN. ²	EST. AREA 687.095
EST. WT.	1.247	LBS/FT.	EST. WT. 1.856
EST. PER.	11.391	IN.	EST. PER. 289.331
OUT PER.	6.283	IN.	OUT PER. 159.588
C.C.D.	2.000	IN.	C.C.D. 50.800
FACTOR 9.5	FINISH M/F	ALLOY & TEMP. 6061	
CKD BY	SCALE 1:1	DWN BY B.A.	DATE 1/14/19

WOLVERINE

2100 MARKET STREET
DECATUR, AL 35816
800-633-3972

THIS DRAWING IS NOT NECESSARILY A COPY OF YOUR ORIGINAL. PLEASE APPROVE DIMENSIONS AND TOLERANCES INDICATED. WOLVERINE ASSUMES NO RESPONSIBILITY EITHER TECHNICAL OR LEGAL FOR HAVING THIS SHAPE MADE. THE CUSTOMER AGREES TO FULLY PROTECT WOLVERINE FROM CLAIMS OF OTHERS RESULTING FROM THIS SHAPE.

SIGNED: _____ DATE: _____

PRINT NAME: _____